

NOTE:
TWO FIBERS AT INPUT AND
TWO FIBERS AT OUTPUT.
FIBERS FUSED TOGETHER.

CODE EXPLANATION

DC1- 0.4 - 3000 / 600 / 1000 - SMA / SMA - GM M

FIBER CORE DIAMETER "FD"
CUSTOMER DEFINED
IN [MILIMETERS] MAX. 2MM

TOTAL LENGTH "TL"
CUSTOMER DEFINED
IN [MILIMETERS]

LEGS LENGTH "L1"
CUSTOMER DEFINED
IN [MILIMETERS]

LEGS LENGTH "L2"
CUSTOMER DEFINED
IN [MILIMETERS]

CONNECTOR TYPE	
SMA	STANDARD SMA 905
SMAF	HIGH POWER SMA
FC/PC	STANDARD FC/PC
ST	STANDARD ST
DIN	STANDARD DIN
CD	CUSTOMER DEFINED

JACKETING TYPE	
N	NONE
GM	GALVANIZED STEEL PVC MONOCOIL
M	METAL
MP	METAL + PVC
S	SILICONE
PT	PTFE
CF	C-FLEX
K	KEVLAR
P	PVC
CD	CUSTOMER DEFINED

BEND PROTECTION	
N	NONE
M	METAL
P	PLASTIC
B	BOOT (RUBBER)
H	HEAT SHRINK TUBE

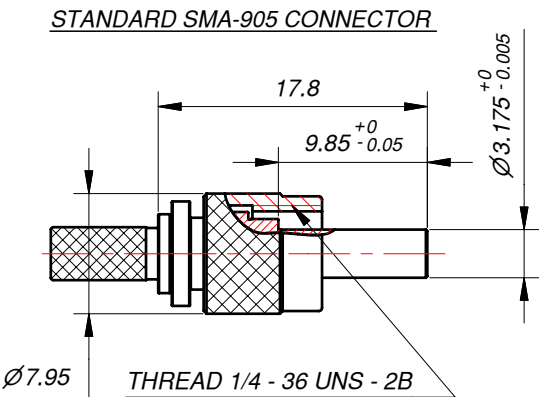

- MULTIMODE OPTICAL FIBER SELECTION:**
- POSSIBLE FIBER TRANSMISSION IN THE RANGE:
 ZLUV 180 - 1200 NM (NA=0.22; 0.26; LOWER NA ON REQUEST).
 ZLWF 400 - 2200 NM (NA=0.22; 0.26; LOWER NA ON REQUEST).
 ZLWFG 400-2200 NM (NA=0.37) GERMANIUM DOPED.
 ZLPUV 250 - 1100 NM (NA=0.37).
 ZLPWF 400 - 2200 NM (NA=0.37).
 ZLHWF 400 - 1600 NM (NA=0.37; 0.48).
 ZLHUV 300 - 1100 NM (NA=0.37; 0.48).
 - STRESS PROOF LOAD 100KPSI.
 - FOR OTHER FIBER PARAMETERS PLEASE LOOK FIBER CATALOG.

TITLE: DC1 - FIBER CABLE DUPLEX CABLE		
SIZE: A2	DRAWING NO.: DC1-001-00	REV.:
FILE NAME: DC1-001-00.idw	ITEM NO.:	
COMPANY: Z-LIGHT, LTD.	CODE NO.:	
HOME PAGE: HTTP://WWW.Z-LIGHT.LV	ORDER NO.:	
SCALE: DO NOT SCALE	DIMENSIONS ARE IN MM	SHEET 1 OF 1