

CUSTOMER DEFINED LENGTH IN [MM]		
L1	L2	L3

DETAIL I

RANDOMIZATION
 RED FIBERS GO TO LEG "B1"
 WHITE FIBERS GO TO LEG "B2"

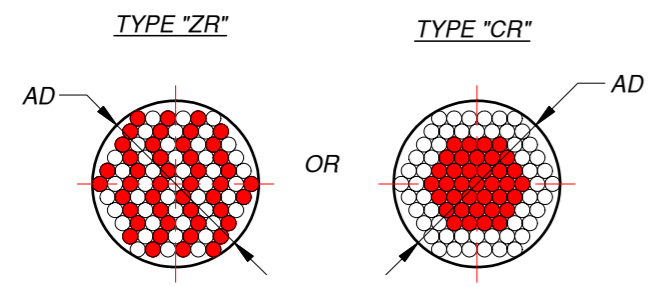

CUSTOMER DEFINED FIBER DIVISION	
PERCENTS [%] OF FIBERS	FIBER DIVISION
	FROM LEG "A" GO TO LEG "B1"
	FROM LEG "A" GO TO LEG "B2"

EXAMPLE:
 60% FIBERS FROM LEG "A" GO TO LEG "B1"
 40% FIBERS FROM LEG "A" GO TO LEG "B2"

CODE EXPLANATION

YFB5 - 2.2 / 1200 / [] / 50 R - S3 - GM

ACTIVE DIAMETER "AD" IN [MM] CUSTOMER DEFINED

LENGTH "L1" IN [MM] CUSTOMER DEFINED

PERCENTS OF FIBERS FROM LEG "A" GO TO LEG "B1" CUSTOMER DEFINED

FIBERS JACKET ARE REMOVED

FERRULES MATERIAL

JACKETING TYPE

TYPE "ZR"	TYPE "CR"	TYPE "CD"
CR	CD	CUSTOMER

S3	STAINLES STEEL
A	ALUMINIUM
BA	BLACK ALUMINIUM
P	PLASTIC
CD	CUSTOMER DEFINED

P	PVC
GM	GALVANIZED STEEL PVC MONOCOIL
SS	STAINLESS STEEL
S	SILICONE
CD	CUSTOMER DEFINED

NOT REMOVED	
R	REMOVED

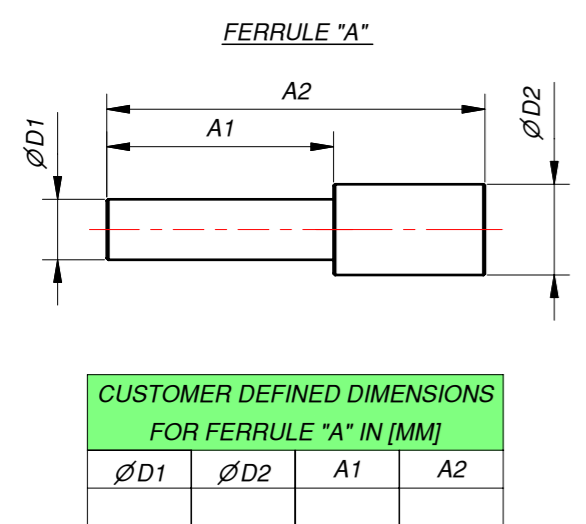

CUSTOMER DEFINED DIMENSIONS FOR FERRULE "A" IN [MM]			
∅D1	∅D2	A1	A2

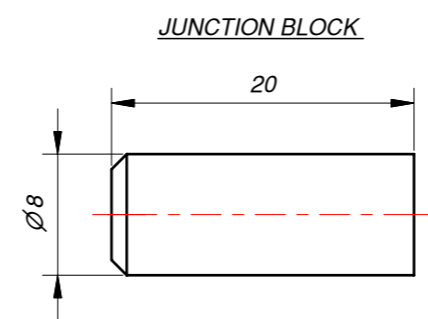
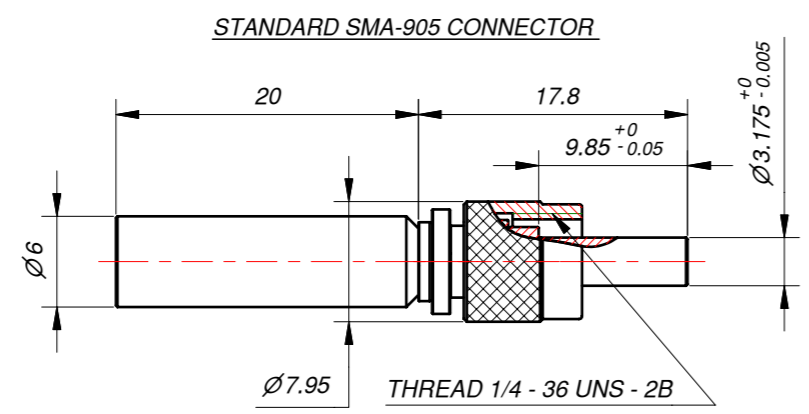

FERRULES COULD BE MADE IN ACCORDANCE WITH CUSTOMER DRAWINGS

- MULTIMODE OPTICAL FIBER SELECTION:**
- POSSIBLE FIBER TRANSMISSION IN THE RANGE:
 ZLUV 180 - 1200 NM (NA=0.22; 0.26; LOWER NA ON REQUEST).
 ZLWF 400 - 2200 NM (NA=0.22; 0.26; LOWER NA ON REQUEST).
 ZLPUV 250 - 1100 NM (NA=0.37).
 ZLPWF 400 - 2200 NM (NA=0.37).
 - STRESS PROOF LOAD 100KPSI.
 - FOR OTHER FIBER PARAMETERS PLEASE LOOK FIBER CATALOG.

TITLE: YFB5 - FIBER BUNDLE FUSED YF - BUNDLE		
SIZE: A2	DRAWING NO.: YFB5-001-00	REV.: A
FILE NAME: YFB5-001-00.idw	ITEM NO.:	
COMPANY: Z-LIGHT, LTD.	CODE NO.:	
HOME PAGE: HTTP://WWW.Z-LIGHT.LV	ORDER NO.:	
SCALE: DO NOT SCALE	DIMENSIONS ARE IN MM	SHEET 1 OF 1