

CUSTOMER DEFINED LENGTH IN [MM]		
L1	L2	L3

**DETAIL I**

RANDOMIZATION  
RED FIBERS GO TO LEG "B1"  
WHITE FIBERS GO TO LEG "B2"

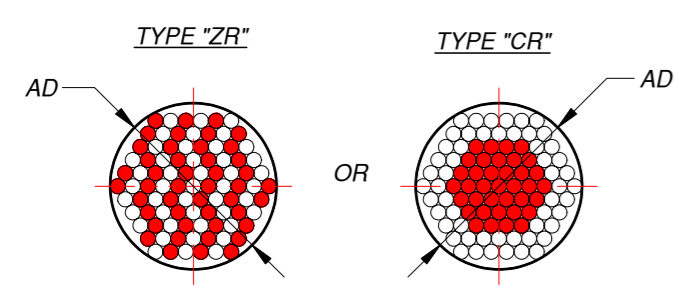

CUSTOMER DEFINED FIBER DIVISION	
PERCENTS [%] OF FIBERS	FIBER DIVISION
	FROM LEG "A" GO TO LEG "B1"
	FROM LEG "A" GO TO LEG "B2"

EXAMPLE:  
60% FIBERS FROM LEG "A" GO TO LEG "B1"  
40% FIBERS FROM LEG "A" GO TO LEG "B2"

**YFB4-2.2 / 1200 / [ ] / 50 R BA GM**

ACTIVE DIAMETER "AD" IN [MM]  
CUSTOMER DEFINED

LENGTH "L1" IN [MM]  
CUSTOMER DEFINED

RANDOMIZATION	
TYPE "ZR"	TYPE "CR"
CR	TYPE "CR"
CD	CUSTOMER

PERCENTS OF FIBERS FROM LEG "A" GO TO LEG "B1"  
CUSTOMER DEFINED

FIBERS JACKET ARE REMOVED	
NOT REMOVED	REMOVED
	R

FERRULES MATERIAL	
S3	STAINLES STEEL
A	ALUMINIUM
BA	BLACK ALUMINIUM
P	PLASTIC
CD	CUSTOMER DEFINED

JACKETING TYPE	
P	PVC
GM	GALVANIZED STEEL
	PVC MONOCOIL
SS	STAINLESS STEEL
S	SILICONE
CD	CUSTOMER DEFINED

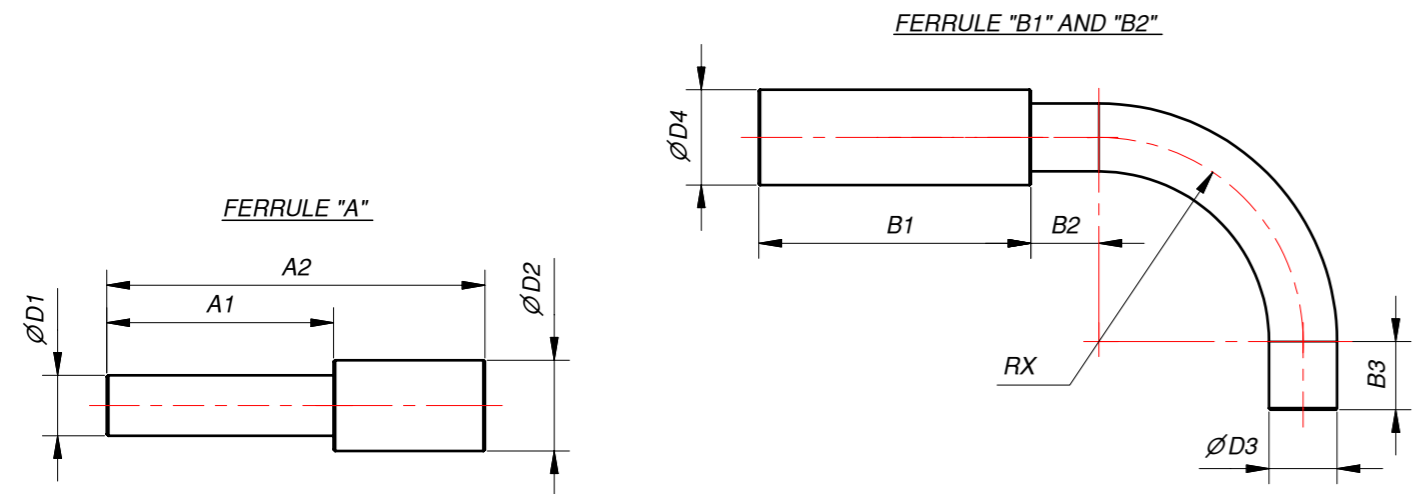

CUSTOMER DEFINED DIMENSIONS FOR FERRULE "A" IN [MM]			
∅D1	∅D2	A1	A2

CUSTOMER DEFINED DIMENSIONS FOR FERRULE "B1" AND "B2" IN [MM]					
∅D3	∅D4	B1	B2	B3	RX

JUNCTION BLOCK DIMENSIONS IN [MM]		
ACTIVE DIAM. AD	∅D5	J
0 - 2.5	8	20
2.5 - 4	13	25
4 - 6	16	30
6 - 10	22	40

- MULTIMODE OPTICAL FIBER SELECTION:**
- POSSIBLE FIBER TRANSMISSION IN THE RANGE:  
ZLUV 180 - 1200 NM (NA=0.22; 0.26; LOWER NA ON REQUEST).  
ZLWF 400 - 2200 NM (NA=0.22; 0.26; LOWER NA ON REQUEST).  
ZLPUV 250 - 1100 NM (NA=0.37).  
ZLPWF 400 - 2200 NM (NA=0.37).
  - STRESS PROOF LOAD 100KPSI.
  - FOR OTHER FIBER PARAMETERS PLEASE LOOK FIBER CATALOG.

FERRULES COULD BE MADE IN ACCORDANCE WITH CUSTOMER DRAWINGS

TITLE: <b>YFB4 - FIBER BUNDLE FUSED YF - BUNDLE</b>		
SIZE: <b>A2</b>	DRAWING NO.: <b>YFB4-001-00</b>	REV.: <b>A</b>
FILE NAME: YFB4-001-00.idw	ITEM NO.:	
COMPANY: Z-LIGHT, LTD.	CODE NO.:	
HOME PAGE: HTTP://WWW.Z-LIGHT.LV	ORDER NO.:	
SCALE: DO NOT SCALE	DIMENSIONS ARE IN MM	SHEET 1 OF 1